

SOLENOID OPERATED HYDRAULIC PILOT DIRECTIONAL VALVE

SWDH-04/06/10G SERIES

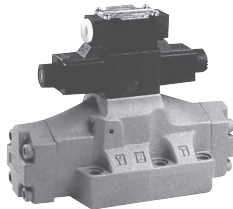

SPECIFICATIONS

Maximum operating pressure :	250 kg/cm ² (Spool 6 type 210 kg/cm ² only).
Rated flow capacity :	04-150 l/min. 06-300 l/min. 10-800 l/min.
Max. flow capacity :	04-250 l/min. 06-500 l/min. 10-1100 l/min.
Minimum pilot pressure :	4.5 kg/cm ² .
Maximum T line back pressure :	140 kg/cm ² .
Maximum frequency of operation :	120 cycle/min.
Filtration :	25 Micron.
Ambient temperature range :	-5°C~60°C.

SWDH-04

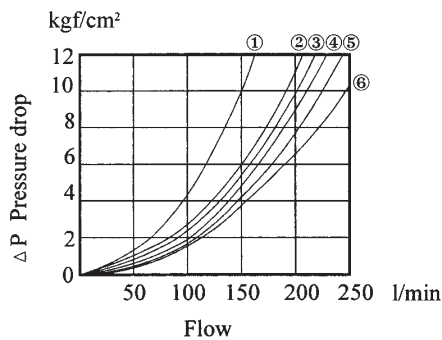

SPOOL TYPE		2	3	4	40	5	6	7	9	10	11	12
Pressure decrease curve number	P → A	5	6	5	5	5	2	5	6	5	5	5
	B → T	2	3	4	4	2	3	2	2	4	4	3
	P → B	5	6	5	5	4	4	5	6	5	5	5
	A → T	4	5	5	5	5	2	5	5	5	5	5
	P → T	-	3	-	-	1	1	-	-	-	-	-

SWDH-06

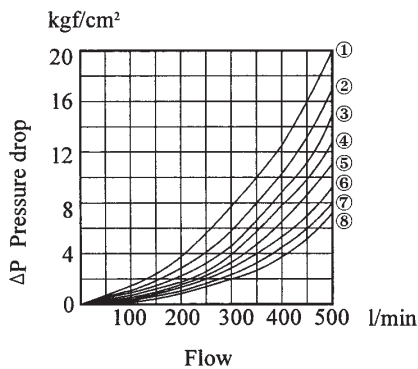

SPOOL TYPE		2	3	4	40	5	6	7	9	10	11	12
Pressure decrease curve number	P → A	8	6	8	8	8	5	6	6	8	8	8
	B → T	5	4	5	5	4	1	4	5	5	4	5
	P → B	8	6	8	8	5	5	6	6	8	5	8
	A → T	7	7	7	7	7	4	7	7	7	7	7
	P → T	-	6	-	-	2	3	-	-	-	-	-

SWDH-10

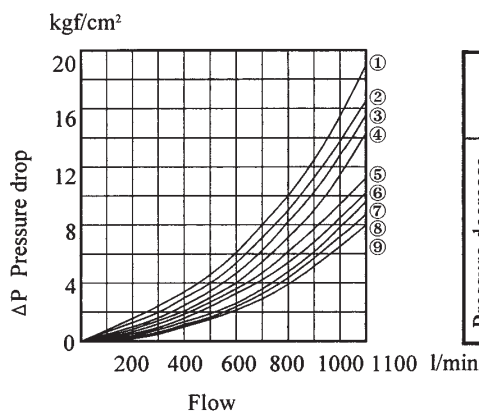

SPOOL TYPE		2	3	4	40	5	6	7	9	10	11	12
Pressure decrease curve number	P → A	9	7	9	9	9	5	7	7	9	9	9
	B → T	6	6	6	6	6	3	6	6	5	6	7
	P → B	9	7	9	9	8	5	7	7	9	8	9
	A → T	8	7	6	8	6	4	7	8	8	7	6
	P → T	-	5	-	-	1	2	-	-	-	-	-

SWDH - 04 / 06 / 10 SERIES

SPECIAL FEATURE

Change of external or internal pilot and drain can be easily accomplished by plugging unplugging.

(see illustration X-pilot Y- drain).

For valve with by pass spool internal pilot supply is necessary to obtain the minimum pilot pressure required at tank line.

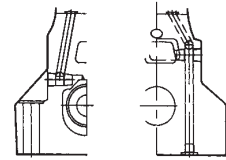

Y-Y SECTION X-X SECTION

***Weight (kgs)**

		04	06	10
Double solenoid	AC	8.3	13.7	44.9
	DC	8.6	14	45.2
Single solenoid	AC	8	13.4	44.6
	DC	8	13.5	44.7

ORDERING CODE

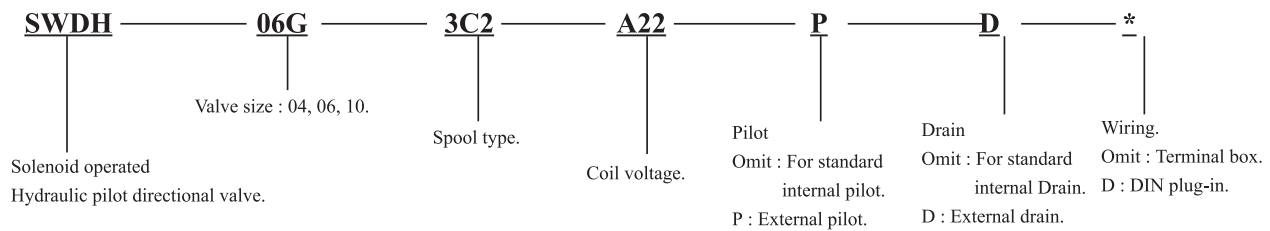

SWDH-04 SERIES

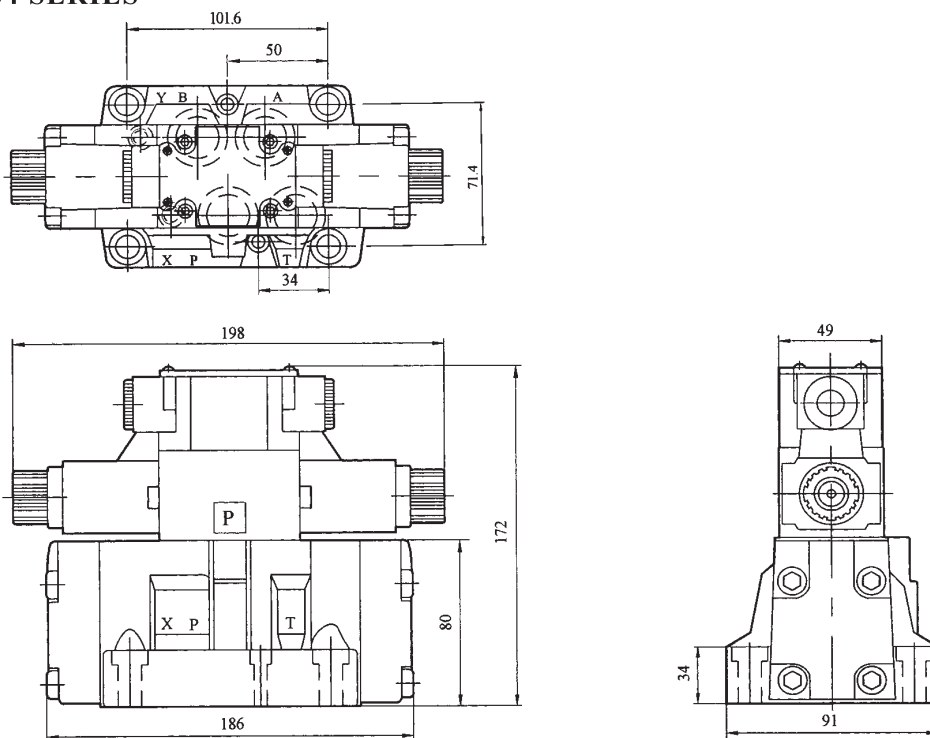

SWDH - 06 / 10 SERIES

SWDH-06 SERIES

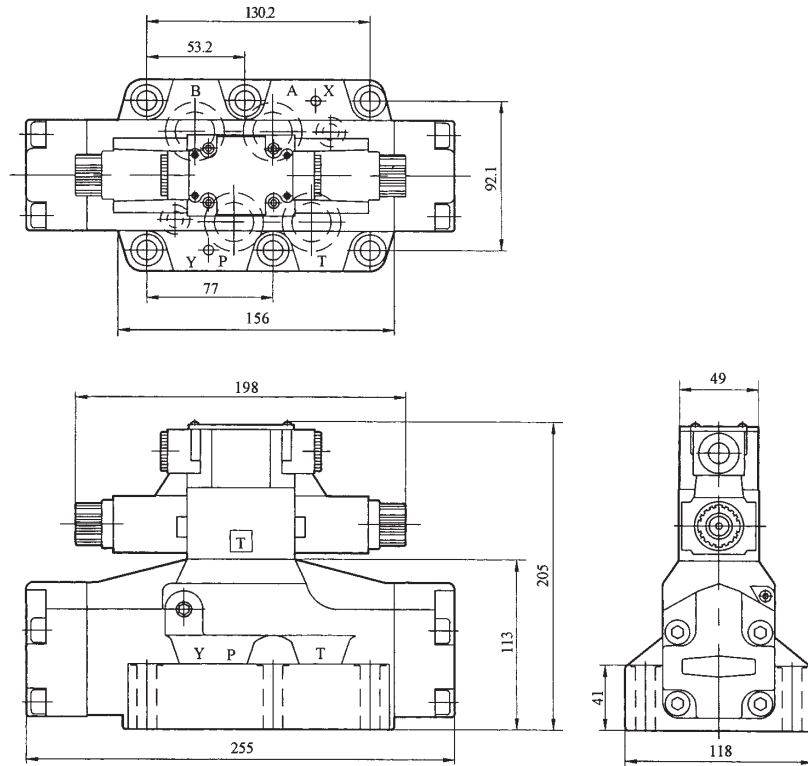

SWDH-10 SERIES

